

冷氣機

遙控器使用說明書

使用前請仔細閱讀本說明書
將本說明書保存起來以備日後所需

目 錄

遙控器型號及主要參數.....	2
功能按鈕.....	4
遙控器的裝配及處置.....	5
顯示屏的名稱及其功能.....	6
如何使用基本功能.....	7
自動模式/製冷模式操作方法.....	7
抽濕模式/送風模式操作方法.....	8
製熱模式(淨冷機無)操作方法.....	9
定時功能.....	10
如何使用高級功能.....	15

注意：

遙控器按鍵設計是基於典型的型號，可能與實際購買的樣式略有不同，以實際形狀為準。

描述的所有功能都由所購買的冷氣機產品完成。如果該產品沒有此功能，按遙控器上的相關按鈕時，不會發生相應的操作。

當遙控器插圖和用戶手冊功能描述有很大差異時，以用戶手冊為準。

遙控器型號及主要參數

型號	RG57H(B)/BG(C)E; RG57H1(B)/BG(C)E; RG57H2(B)/BG(C)EF; RG57H3(B)/BG(C)EFU1; RG57H3(B)/BG(C)EF; RG57H1(B)/BG(C)E-M; RG57H(B)/BG(C)EU1; RG57H4(B)/BG(C)EFU1; RG57H(B)/BG(C)E-M; RG57H(B)/BG(C)EU1-M; RG57H3(B)/BG(C)EFU1-M; RG57H1(B)/BG(C)EU1-M;RG57H5(B)/BG(C)CEU1; RG57H5(B)/BG(C)CE; RG57H1(B)/BG(C)EU1; RG57H2(B)/BG(C)EFU1; RG57H3(B)/BG(C)EF; RG57H4(B)/BG(C)EF; RG57H2(B)/BG(C)EF-M; RG57H2(B)/BG(C)EFU1-M
額定電壓	3.0V (兩節 R03/LR03 乾電池)
信號到達 距離	8m
使用條件	-5°C ~ 60°C (23°F~140°F)

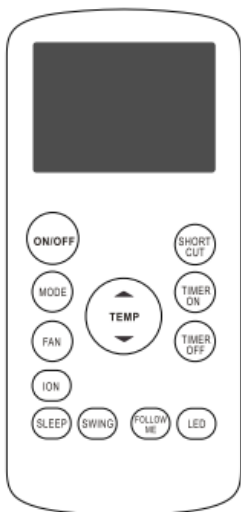
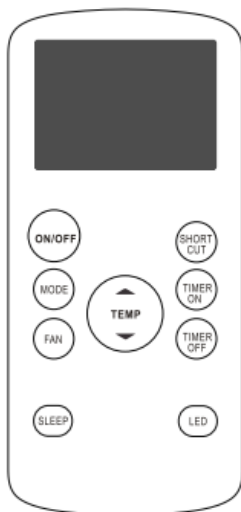
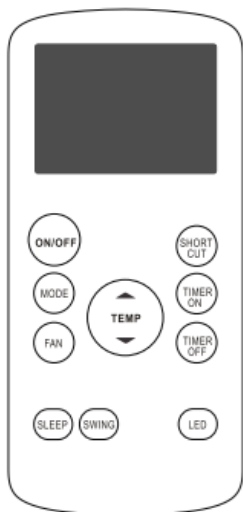

RG57H(B)/BG(C)E RG57H(B)/BG(C)EU1 RG57H(B)/BG(C)EU1-M RG57H(B)/BG(C)E-M	RG57H1(B)/BG(C)E; RG57H1(B)/BG(C)E-M RG57H1(B)/BG(C)EU1-M RG57H1(B)/BG(C)EU1	RG57H2(B)/BG(C)EF RG57H2(B)/BG(C)EF-M RG57H2(B)/BG(C)EFU1 RG57H2(B)/BG(C)EFU1-M
--	---	--

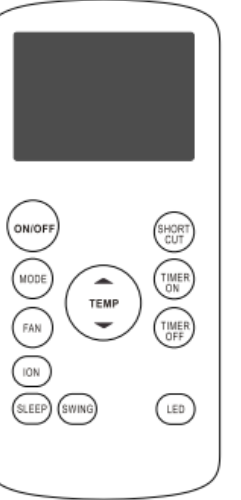
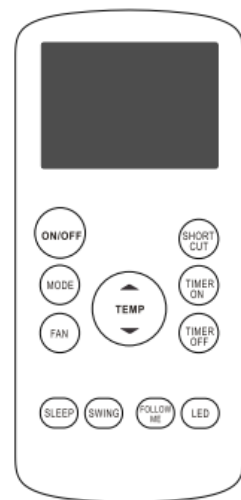
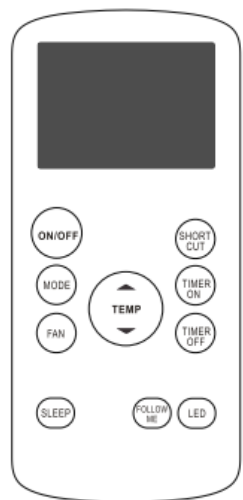

RG57H3(B)/BG(C)EF RG57H3(B)/BG(C)EFU1 RG57H3(B)/BG(C)EFU1-M RG57H3(B)/BG(C)EF-M	RG57H4(B)/BG(C)EFU1 RG57H4(B)/BG(C)EF	RG57H5(B)/BG(C)E RG57H5(B)/BG(C)EU1
--	--	--

功能按鈕

在開始使用新的冷氣機之前，請務必熟識其遙控器。以下是遙控器本身的簡要介紹。有關如何操作冷氣機的說明，請參閱本手冊的“如何使用基本功能”部分。

開啟/關閉

打開或關閉設備

運行模式

滾動選擇運行模式如下：
自動-製冷-除濕-製熱-送風

注意：如果您購買的冷氣機為淨冷機型，請不要選擇製熱模式。淨冷機不支持製熱模式。

風速設置

滾動選擇以下風擋：
自動-低風-中風-高風

負離子

按下該按鈕，離子發生器通電，將有助於去除空氣中的花粉和雜質。

睡眠模式按鈕

在睡覺的時候節省能源。

強勁按鈕

使設備在最短的時間內達到預設溫度

溫度調整按鈕

以 1°C 為增量增加溫度。最高溫度為 30°C。

溫度調整按鈕

以 1°C 為增量降低溫度。最低溫度為 17°C。

定時開機按鈕

設置定時開機功能（請參閱如何使用基本功能）

定時關機按鈕

設置定時關機功能（請參閱如何使用基本功能）

LED 按鈕

打開和關閉室內機的 LED 顯示屏。如果您在睡覺時對光線敏感，可以按下 LED 按鈕關閉室內機的 LED 顯示屏。再次按下該按鈕將其重新打開。

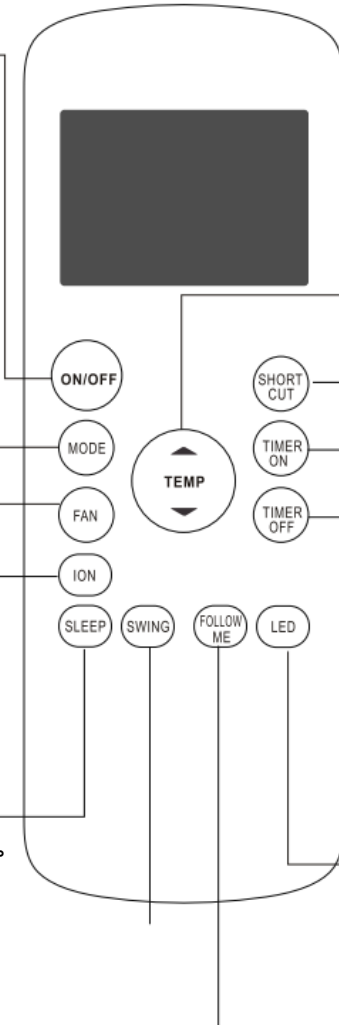

注意：

搖擺，負離子，隨身感和風扇中速檔等功能是根據冷氣機機型選配的。

隨身感

溫度感應和室溫顯示按鈕。

遙控器的裝配及處置

不清楚功能是什麼？

有關如何使用冷氣機的詳細說明，請參閱本手冊的“如何使用基本功能”和“如何使用高級功能”部分。

特別說明

- 您的遙控器上的按鈕設計可能與所示例例略有不同。
 - 如果室內機沒有特殊功能，按遙控器上的功能按鈕將不起作用。
- 當遙控器插圖和用戶手冊功能描述有很大差異時，以用戶手冊為準

插入和更換電池

您的冷氣機配有兩節 AAA 電池。使用前請將電池放在遙控器中。

1. 從遙控器向後滑動後蓋，暴露電池倉。
2. 插入電池，注意將電池的 (+) 和 (-) 端與電池倉內的符號相符。
3. 將電池蓋滑回到位。



電池注意事項

為獲得最佳產品性能：

- 不要混合使用新舊電池或不同類型的電池。
- 如果您不打算使用設備超過 2 個月，請勿將電池留在遙控器中。



電池處理

不要將電池作為未分類的城市垃圾處理。請參閱當地法律，妥善處理電池。

遙控器使用的提示

遙控器必須在裝置的 8 米以內使用。
收到遙控信號後，本機將發出蜂鳴聲。
窗簾，其他材料和陽光直射可能會干擾紅外信號接收器。
如果遙控器不能使用 2 個月以上，請取出電池。

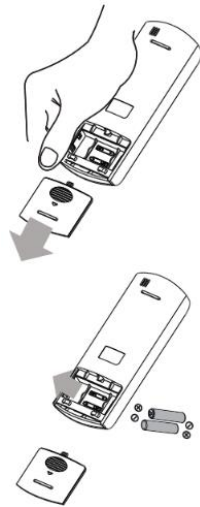

如何使用基本功能

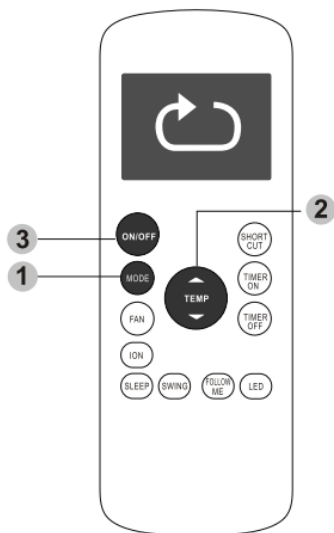

設定溫度

單位的工作溫度範圍為 17°C-30°C。可以以 1°C 為增量增加或減少設定溫度。

自動模式

在 AUTO 模式下，本機將根據設定的溫度自動選擇製冷 COOL，送風 FAN，製熱 HEAT 或抽濕 DRY 模式。

1. 按模式 MODE 按鈕選擇自動模式。
2. 使用 Temp ▲ 或 Temp ▼ 按鈕設置所需的溫度。

3. 按 ON / OFF 按鈕啟動設備。

注意：自動模式(AUTO)下不可以設置風速。淨冷機型無製熱功能，會自動跳過。

製冷模式

1. 按 MODE 按鈕選擇 COOL 模式。

2. 使用 Temp ▲ 或 Temp ▼ 按鈕設置所需的溫度。

3. 按 FAN 按鈕選擇風扇轉速：自動，低速，中速或高速。

4. 按 ON / OFF 按鈕啟動本機。

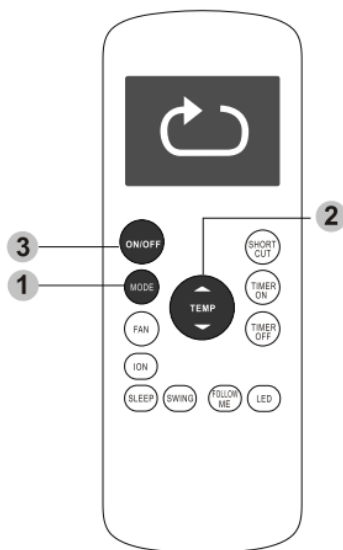

如何使用基本功能

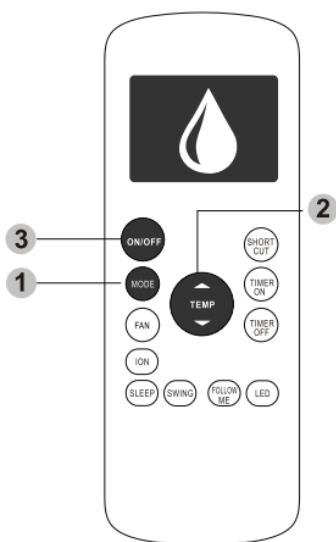

抽濕模式

1. 按 MODE 按鈕選擇抽濕 DRY 模式。

2. 使用 Temp ▲ 或 Temp ▼ 按鈕設置所需的溫度。

3. 按 ON / OFF 按鈕啟動本機。

注意：在抽濕模式下不可以更改風扇速度。

送風模式

1. 按 MODE 按鈕選擇風扇模式。

2. 按 FAN 按鈕選擇風扇轉速：自動，低速，中速或高速。

3. 按 ON / OFF 按鈕啟動設備。

注意：您可以在風扇模式下設置溫度。

因此，您的遙控器的 LCD 屏幕不會顯示溫度。

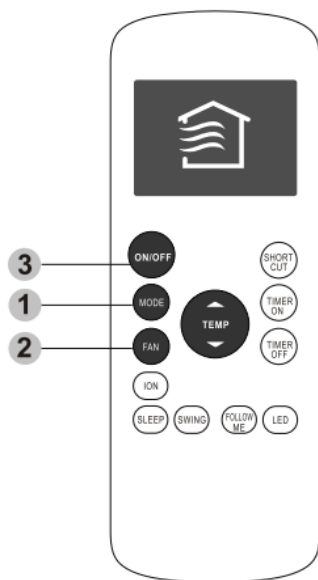

如何使用基本功能

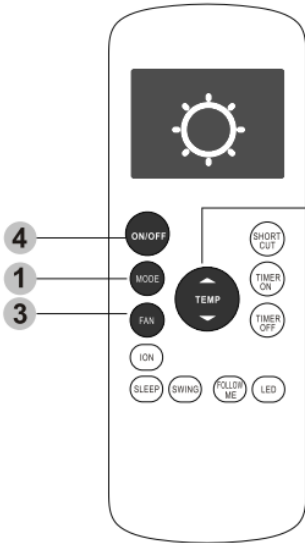

製熱模式

1. 按 MODE 按鈕選擇製熱模式。
2. 使用 Temp ▲ 或 Temp ▼ 按鈕設置所需的溫度。
- 2 3. 按風速 FAN 按鈕選擇風扇轉速：自動，低速，中速或高速。
4. 按 ON / OFF 按鈕啟動本機。

注意：由於室外溫度下降，您的冷氣機的製熱功能的性能可能會受到影響。在這種情況下，我們建議將冷氣機與其他加熱設備配合使用。

注意：淨冷機型無製熱功能。

設置定時功能

您的冷氣機有兩個定時器相關的功能：

- 定時器 ON - 設置定時器的時間量，到時間後冷氣機會自動開啟。
- 定時器 OFF - 設置冷氣機自動關閉的時間量。

定時開機功能

定時開機功能允許您設置冷氣機自動開啟的時間，例如當您從工作回家時。

1. 按下 TIMER ON 按鈕。默認情況下，您設置的最後一個時間段和“h”（表示小時）將顯示在顯示屏上。
注意：此數字表示您希望本機打開的當前時間之後的時間。
例如，如果將 TIMER 設置為 2 小時，屏幕上將出現“2.0h”，2 小時後冷氣機將開啟。
2. 反復按下 TIMER ON 按鈕，設置您希望冷氣機打開的時間。
3. 等待 2 秒鐘，然後啟動 TIMER ON 功能被激活。遙控器上的數字顯示器將返回到溫度顯示。

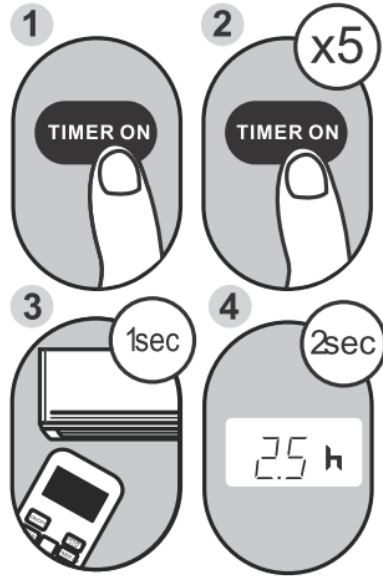

例：設定產品 2.5 小時後開機。

定時關閉功能

定時關閉功能允許您設置一個時間量，在此之後，冷氣機將自動關閉，例如您醒來時。

1. 按 TIMER OFF 按鈕。默認情況下，您設置的最後一個時間段和“h”（表示小時）將顯示在顯示屏上。

注意：該數字為表示您希望冷氣機關閉的當前時間之後的時間量。

例如，如果將 TIMER OFF 設置為 2 小時，“2.0h”將出現在屏幕上，並且冷氣機將在 2 小時後關閉。

2. 反復按 TIMER OFF 按鈕設置要關閉冷氣機的時間。
3. 等待 2 秒鐘，然後 TIMER OFF 功能被激活。遙控器上的數字顯示將返回到溫度顯示。

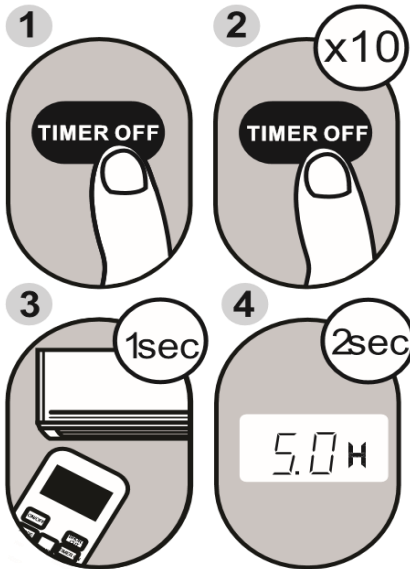

例：設置冷氣機 5 小時後關閉。

注意：

當設置 TIMER ON 或 TIMER OFF 功能時，每按一次，時間將增加 30 分鐘，最多 10 小時。10 小時後，每按一次，增加 1 小時，最多 24 小時。計時器將在 24 小時後恢復為零。

您可以通過將其定時器設置為 “0.0h” 關閉任何一功能。

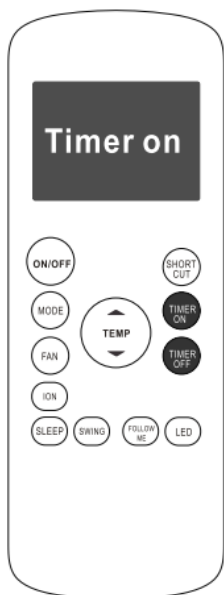

持續按 TIMER ON 或
TIMER OFF，直到達到
所需的時間。

同時設置定時開啟和定時關閉

請記住，您為兩個功能設置的時間段是指當前時間之後的幾個小時。
例如，說當前時間是 1:00PM，並且希望本機在 7:00PM 自動打開。
您希望它運行 2 小時，然後在 9:00 PM 自動關閉。

執行以下操作：

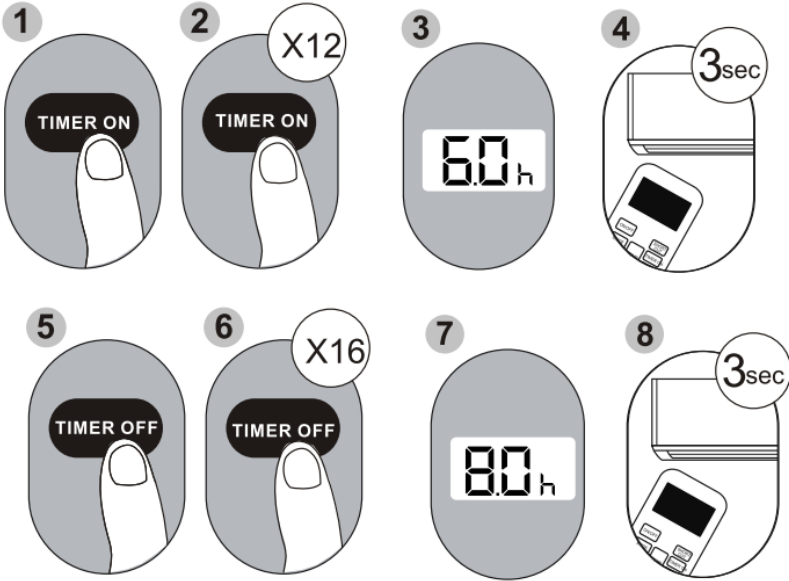

示例：設置冷氣機在 6 小時後打開，操作 2 小時，然後關閉（參見下圖）

您的遙控器會顯示

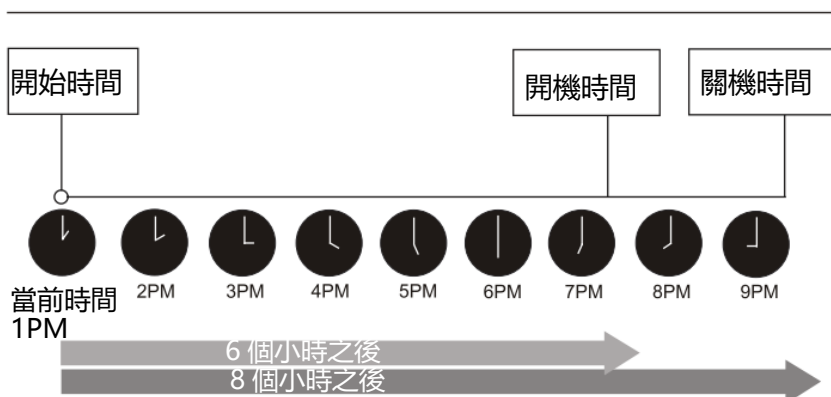
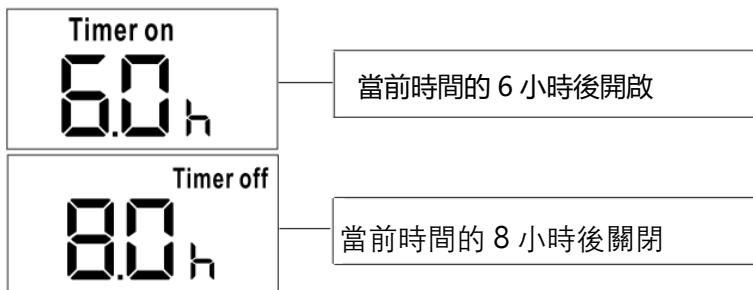

如何使用高級功能

睡眠功能

睡眠功能用於在睡眠時減少能量消耗（並且不需要相同的溫度設置以保持舒適度）。

注意：睡眠功能在送風 FAN 或抽濕 DRY 模式下不可用。

擺風功能

用於關閉或開啟百葉窗運動並設置所需的上下氣流方向。

每按一次，百葉窗的角度變化 6 度（某些機型沒有）。如果持續按住 2 秒鐘以上，則會激活百葉窗自動擺動功能。

隨身感功能

隨身感功能可以進行控制，以測量其當前位置的溫度。當使用自動，製冷或製熱模式時，從遙控器（而不是室內機本身）測量環境溫度將使冷氣機能夠優化周圍的溫度，並確保最大的舒適度。

1. 按 FOLLOW ME 按鈕激活功能。遙控器每三分鐘發送一次溫度信號到室內機。
2. 再次按 FOLLOW ME 按鈕關閉此功能。

快捷功能

- 於恢復當前設置或恢復以前的設置。
- 當遙控器打開時，按此按鈕，冷氣機將自動恢復為之前的設置，包括操作模式，設置溫度，風扇速度級別和睡眠功能（如果已激活）。
- 如果按下 2 秒鐘以上，系統將自動恢復當前的操作設置，包括操作模式，設置溫度，風扇速度級別和睡眠功能（如果已激活）。

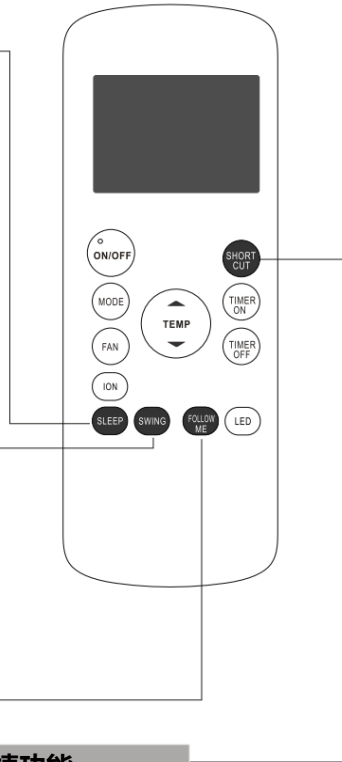

注意：

遙控器按鈕設計基於典型型號，可能與您購買的實際型號略有不同，以實際形狀為準。

所描述的所有功能均由冷氣機完成，如果冷氣機沒有此功能，則按遙控器上的相關按鈕時，不會發生相應的操作。在功能說明上，遙控器圖示和用戶手冊之間存在較大差異時，以用戶手冊上的描述為準。

設計和規格如有更改，恕不另行通知。

有關詳細信息，請諮詢銷售代理商或製造商。

AIR CONDITIONER

REMOTE CONTROL ILLUSTRATION

Thank you very much for purchasing our air conditioner. Please read this owner's manual carefully before using your air conditioner. Keep it for future reference.

CONTENTS

Remote control Specifications.....	2
Function buttons	3
Handling the remote control....	4
Remote LED screen indicators	5
How to use the basic functions.....	6
How to use the advanced functions	13

Remote Control Specifications

Model	RG57H(B)/BG(C)E; RG57H1(B)/BG(C)E; RG57H2(B)/BG(C)EF;RG57H3(B)/BG(C)EFU1; RG57H3(B)/BG(C)EF;RG57H1(B)/BG(C)E-M;RG57H(B)/BG(C)EU1;RG57H4(B)/BG(C)EFU1; RG57H(B)/BG(C)E-M;RG57H(B)/BG(C)EU1-M;RG57H3(B)/BG(C)EFU1-M; RG57H1(B)/BG(C)EU1-M;RG57H5(B)/BG(C)CEU1;RG57H5(B)/BG(C)CE;RG57H1(B)/BG(C)EU1; RG57H2(B)/BG(C)EFU1;RG57H3(B)/BG(C)EF;RG57H4(B)/BG(C)EF;RG57H2(B)/BG(C)EF-M; RG57H2(B)/BG(C)EFU1-M
Rated Voltage	3.0V(Dry batteries R03/LR03×2)
Signal Receiving Range	8m
Environment	-5°C~60°C(23°F~140°F)

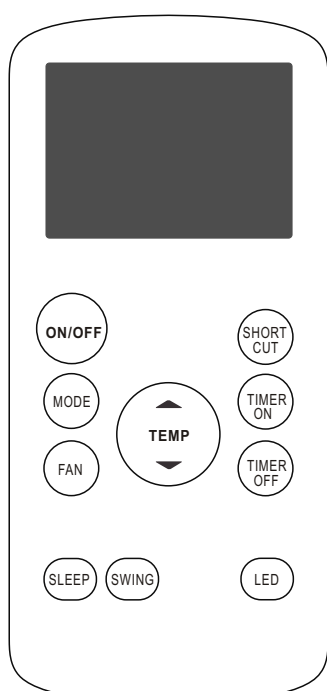

RG57H(B)/BG(C)E
RG57H(B)/BG(C)EU1
RG57H(B)/BG(C)EU1-M
RG57H(B)/BG(C)E-M

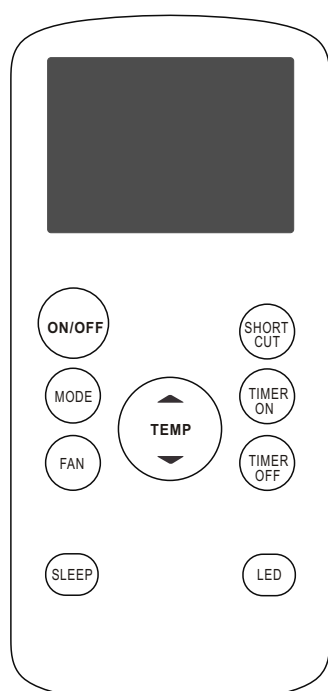

RG57H1(B)/BG(C)E;
RG57H1(B)/BG(C)E-M
RG57H1(B)/BG(C)EU1-M
RG57H1(B)/BG(C)EU1

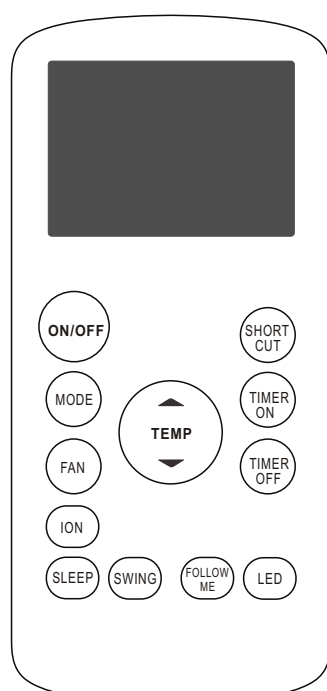

RG57H2(B)/BG(C)EF
RG57H2(B)/BG(C)EF-M
RG57H2(B)/BG(C)EFU1
RG57H2(B)/BG(C)EFU1-M

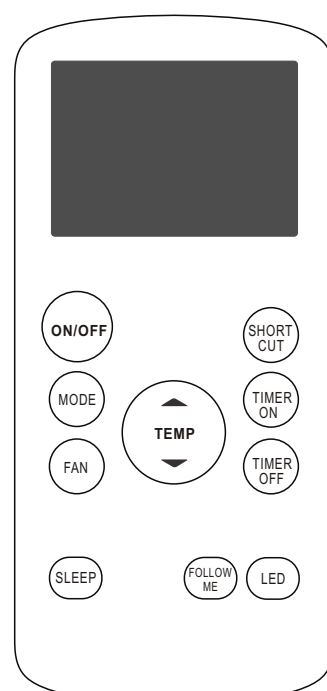

RG57H3(B)/BG(C)EF
RG57H3(B)/BG(C)EFU1
RG57H3(B)/BG(C)EFU1-M
RG57H3(B)/BG(C)EF-M

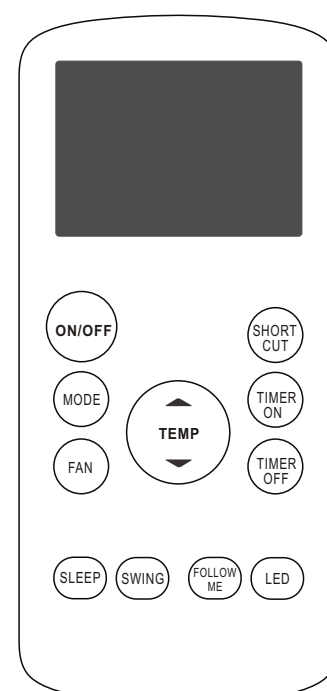

RG57H4(B)/BG(C)EFU1
RG57H4(B)/BG(C)EF

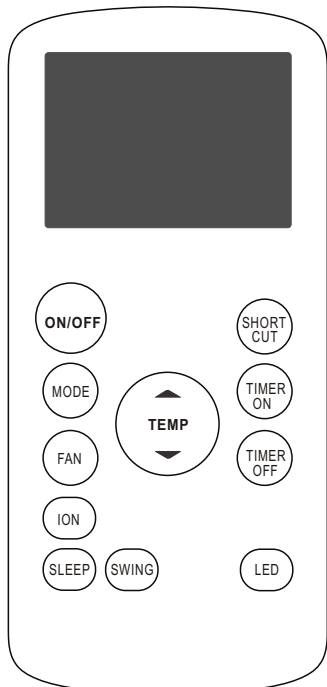

RG57H5(B)/BG(C)E
RG57H5(B)/BG(C)EU1

Function Buttons

Before you begin using your new air conditioner, make sure to familiarize yourself with its remote control. The following is a brief introduction to the remote control itself. For instructions on how to operate your air conditioner, refer to the **How to Use Basic Functions** section of this manual.

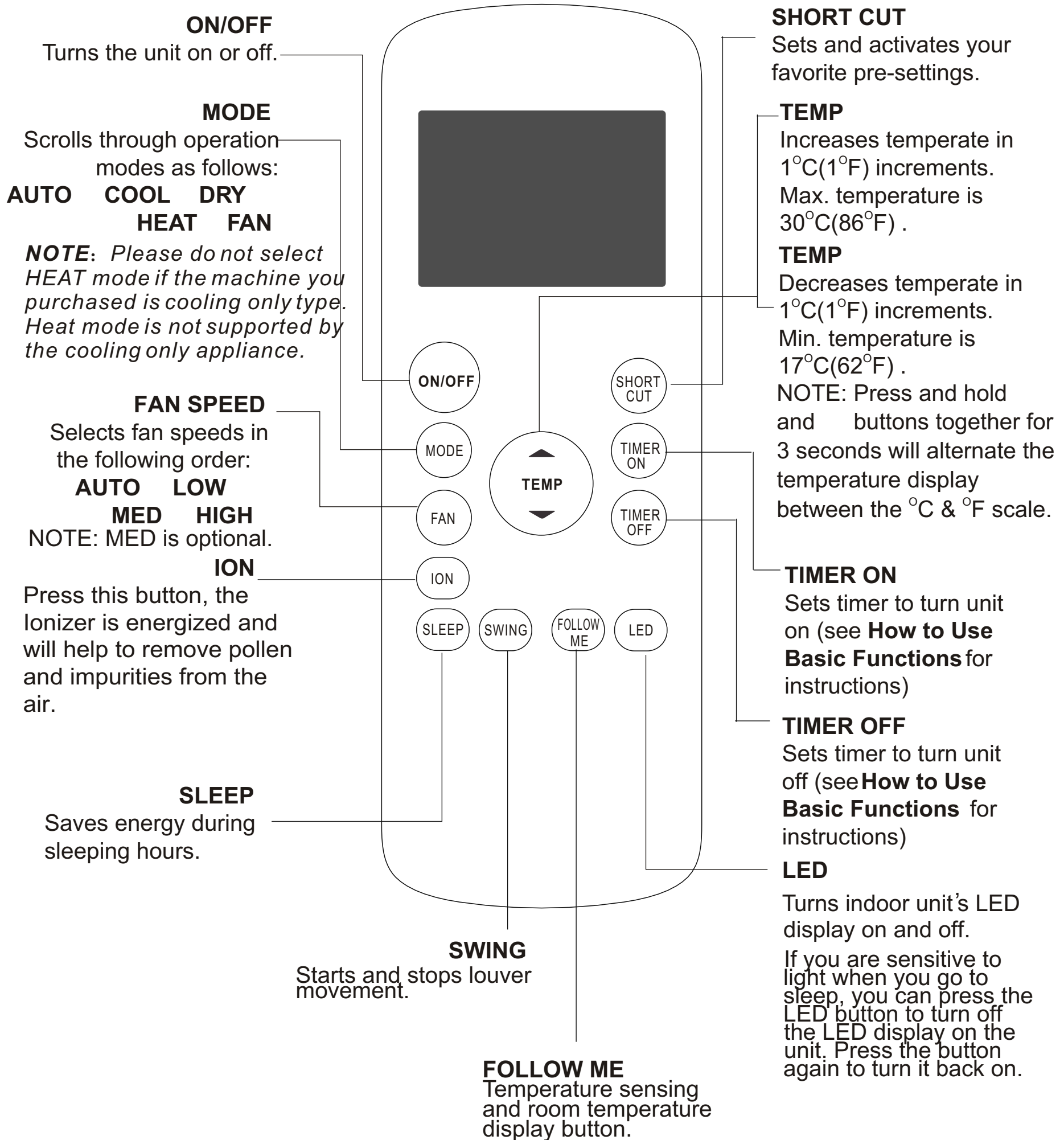

NOTE:
Swing, Ion, Follow me and Med fan speed features are optional.

Handling The Remote Control

NOT SURE WHAT A FUNCTION DOES?

Refer to the How to Use Basic Functions and **How to Use Advanced Functions** sections of this manual for a detailed description of how to use your air conditioner.

SPECIAL NOTE

- Button designs on your unit may differ slightly from the example shown.
- If the unit does not have a particular function, pressing that function's button on the remote control will have no effect.
- When there are wide differences between "Remote control Illustration" and "USER'S MANUAL" on function description, the description of "USER'S MANUAL" shall prevail.

Inserting and Replacing Batteries

Your air conditioning unit comes with two AAA batteries. Put the batteries in the remote control before use.

1. Slide the back cover from the remote Control downward, exposing the battery compartment.
2. Insert the batteries, paying attention to match up the (+) and (-) ends of the batteries with the symbols inside the battery compartment.
3. Slide the battery cover back into place.

! BATTERY NOTES

For optimum product performance:

- Do not mix old and new batteries, or batteries of different types.
- Do not leave batteries in the remote control if you don't plan on using the device for more than 2 months.



BATTERY DISPOSAL

Do not dispose of batteries as unsorted municipal waste. Refer to local laws for proper disposal of batteries.

TIPS FOR USING REMOTE CONTROL

- The remote control must be used within 8 meters of the unit.
- The unit will beep when remote signal is received.
- Curtains, other materials and direct sunlight can interfere with the infrared signal receiver.
- Remove batteries if the remote will not be used more than 2 months.

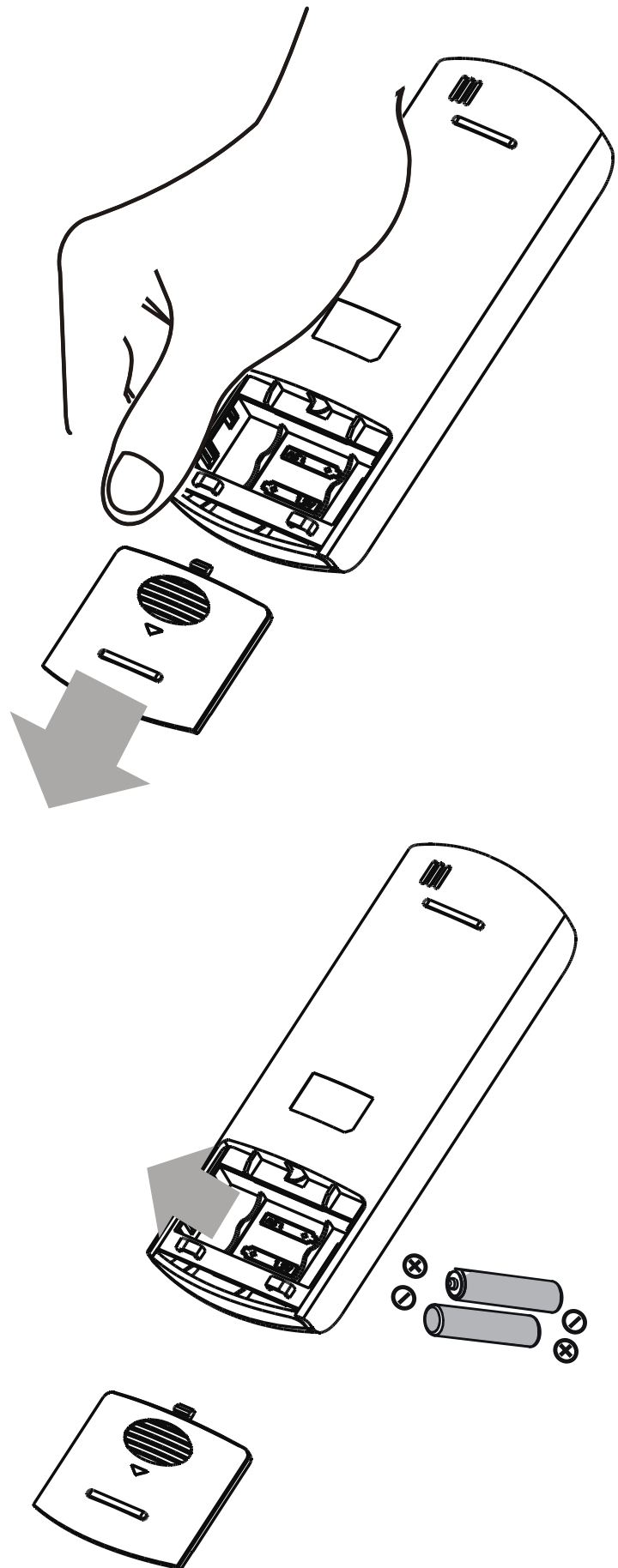

How To Use The Basic Functions

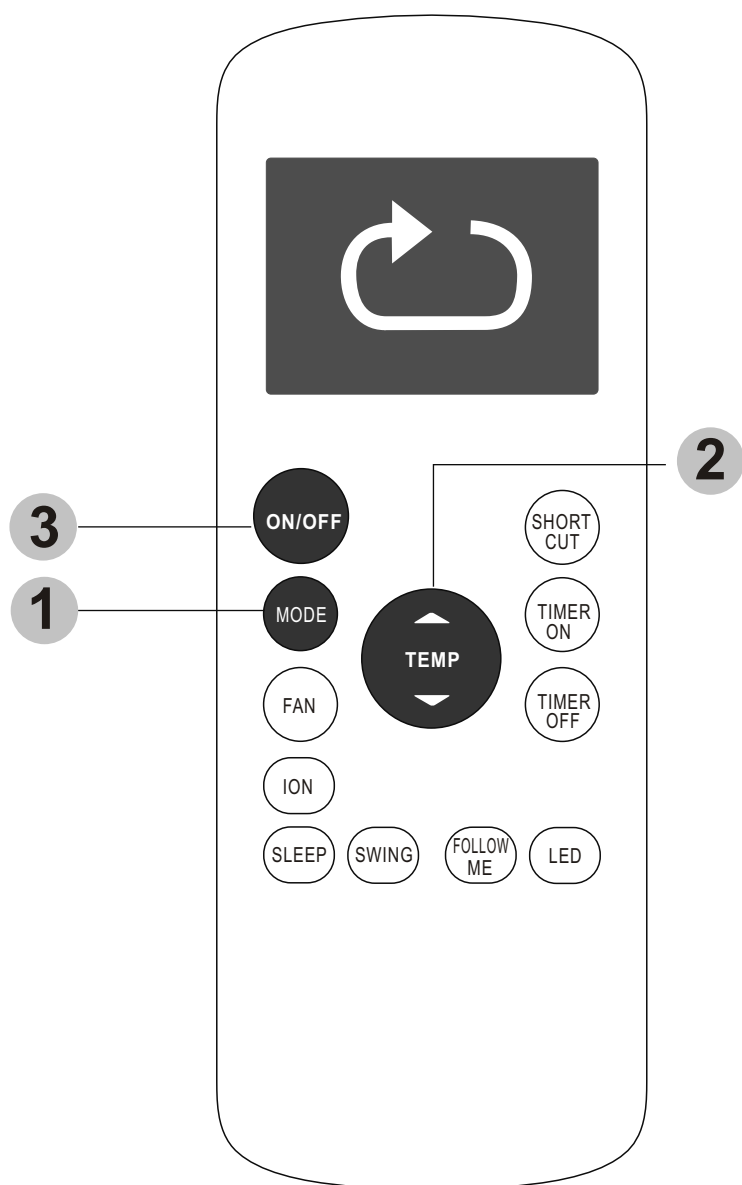

SETTING TEMPERATURE

The operating temperature range for units is 17-30°C(62°F-86°F). You can increase or decrease the set temperature in 1°C(1°F) increments.

AUTO operation

In **AUTO** mode, the unit will automatically select the COOL, FAN, HEAT or DRY mode based on the set temperature.

1. Press the **MODE** button to select Auto mode.
2. Set your desired temperature using the **Temp ▲** or **Temp ▼** button.
3. Press the **ON/OFF** button to start the unit.

NOTE: FAN SPEED can't be set in Auto mode.

COOL operation

1. Press the **MODE** button to select **COOL** mode.
2. Set your desired temperature using the **Temp ▲** or **Temp ▼** button.
3. Press the **FAN** button to select the fan speed: AUTO, LOW, MED, or HIGH.
4. Press the **ON/OFF** button to start the unit.

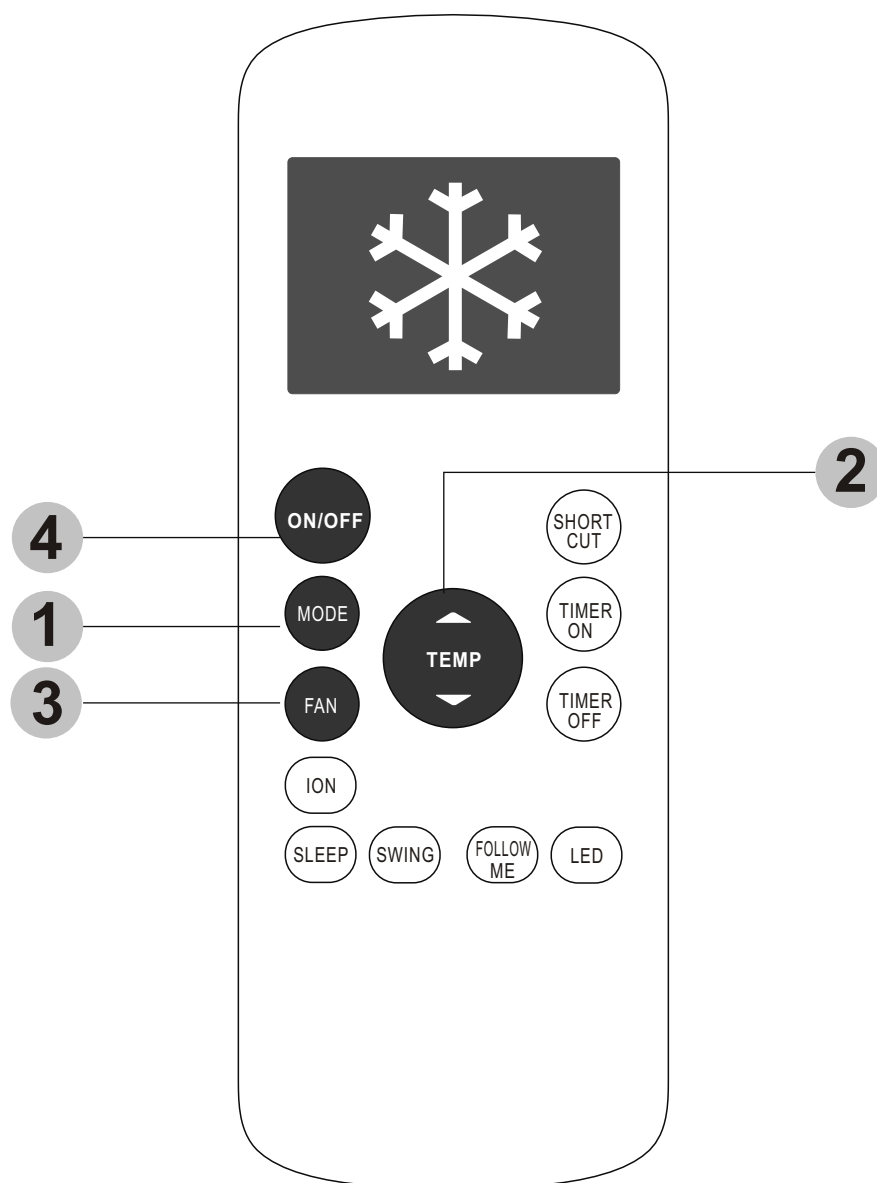

How To Use The Basic Functions

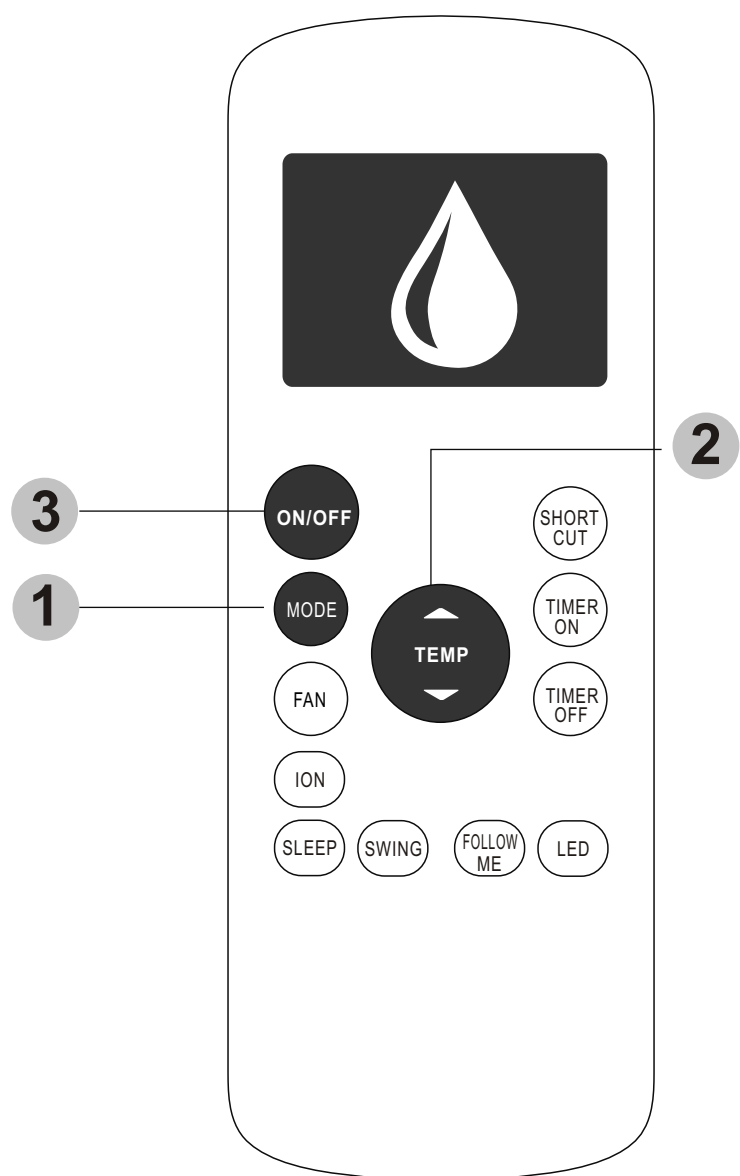

DRY operation(dehumidifying)

1. Press the **MODE** button to select **DRY** mode.
2. Set your desired temperature using the **Temp**▲ or **Temp**▼ button.
3. Press the **ON/OFF** button to start the unit.

NOTE: **FAN SPEED** can't be changed in DRY mode.

FAN operation

1. Press the **MODE** button to select FAN mode.
2. Press **FAN** button to select the fan speed: AUTO, LOW, MED or HIGH.
3. Press the **ON/OFF** button to start the unit.

NOTE: You can't set temperature in FAN mode. As a result, your remote control's LCD screen will not display temperature.

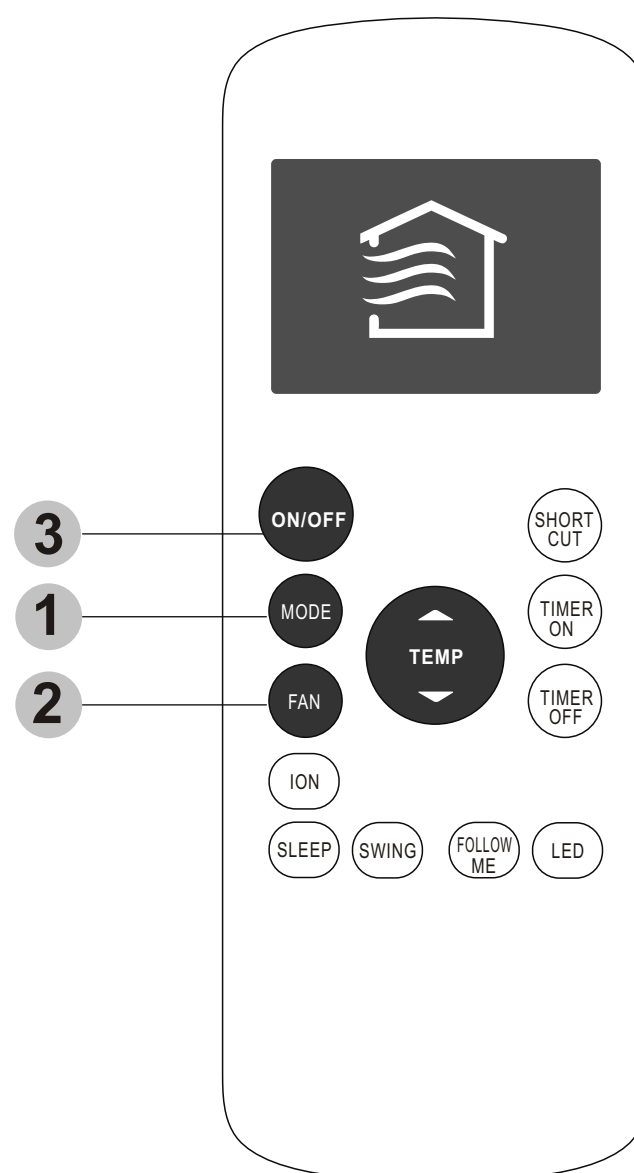

How To Use The Basic Functions

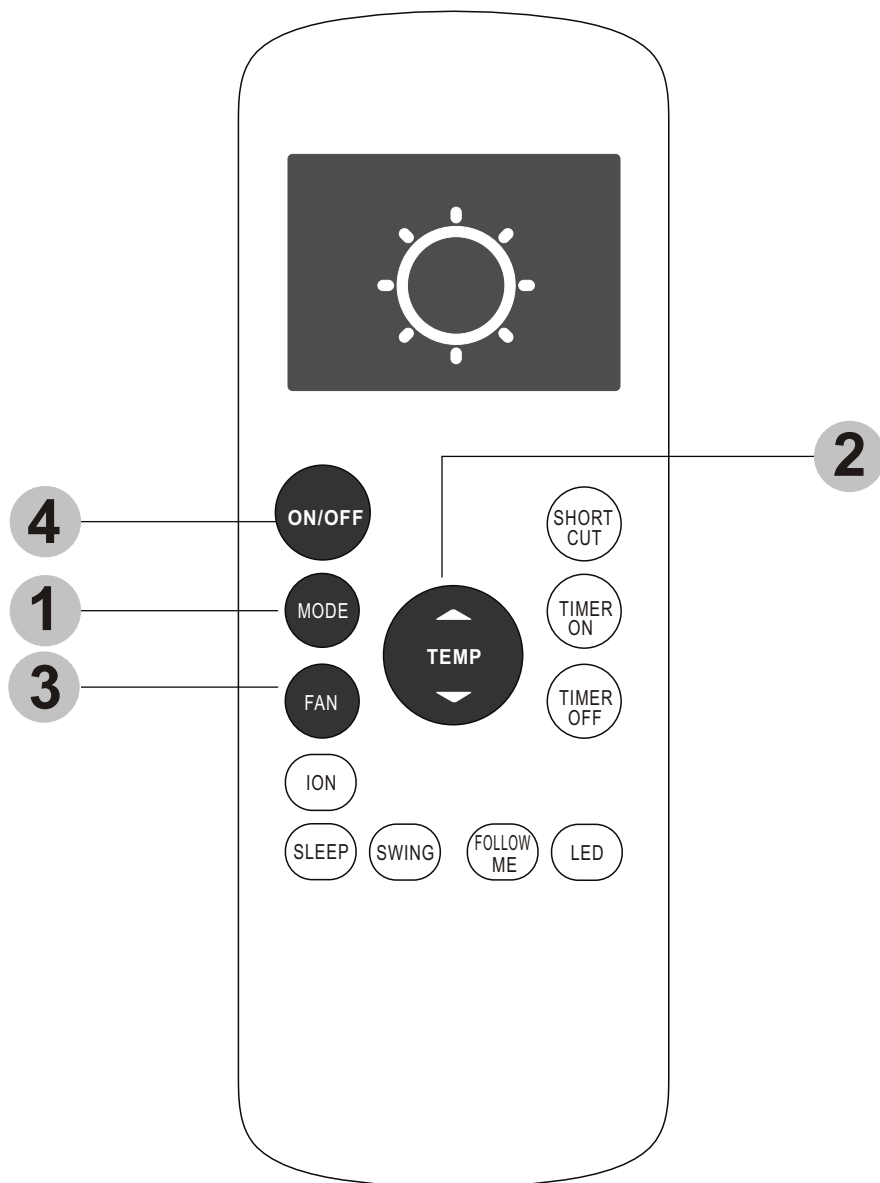

HEAT operation

1. Press the **MODE** button to select **HEAT** mode.
2. Set your desired temperature using the **Temp** ▲ or **Temp** ▼ button.
3. Press the **FAN** button to select the fan speed: AUTO, LOW, MED, or HIGH.
4. Press the **ON/OFF** button to start the unit.

NOTE: As outdoor temperature drops, the performance of your unit's HEAT function may be affected. In such instances, we recommend using this air conditioner in conjunction with other heating appliance. *Heat mode is not supported by the cooling only appliance.*

Setting the TIMER function

Your air conditioning unit has two timer-related functions:

TIMER ON- sets the amount of timer after which the unit will automatically turn on.

TIMER OFF- sets the amount of time after which the unit will automatically turn off.

TIMER ON function

The **TIMER ON** function allows you to set a period of time after which the unit will automatically turn on, such as when you come home from work.

1. Press the **TIMER ON** button. By default, the last time period that you set and an "h" (indicating hours) will appear on the display.

Note: This number indicates the amount of time after the current time that you want the unit to turn on.

For example, if you set **TIMER ON** for 2 hours, " 2.0h " will appear on the screen, and the unit will turn on after 2 hours.

2. Press the **TIMER ON** button repeatedly to set the time when you want the unit to turn on.
3. Wait 2 seconds, then the **TIMER ON** function will be activated. The digital display on your remote control will then return to the temperature display.

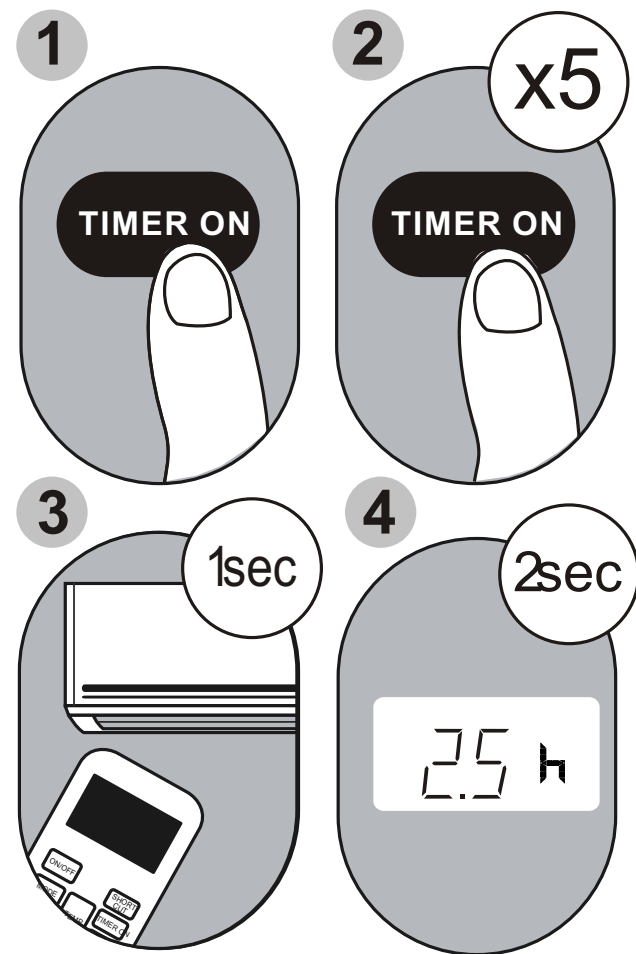

Example: Setting unit to turn on after 2.5 hours.

TIMER OFF function

The **TIMER OFF** function allows you to set a period of time after which the unit will automatically turn off, such as when you wake up.

1. Press the **TIMER OFF** button. By default, the last time period that you set and an "h" (indicating hours) will appear on the display.
Note: This number indicates the amount of time after the current time that you want the unit to turn off. For example, if you set **TIMER OFF** for 2 hours, " 2.0h " will appear on the screen, and the unit will turn off after 2 hours.
2. Press the **TIMER OFF** button repeatedly to set the time when you want the unit to turn off.
3. Wait 2 seconds, then the **TIMER OFF** function will be activated. The digital display on your remote control will then return to the temperature display.

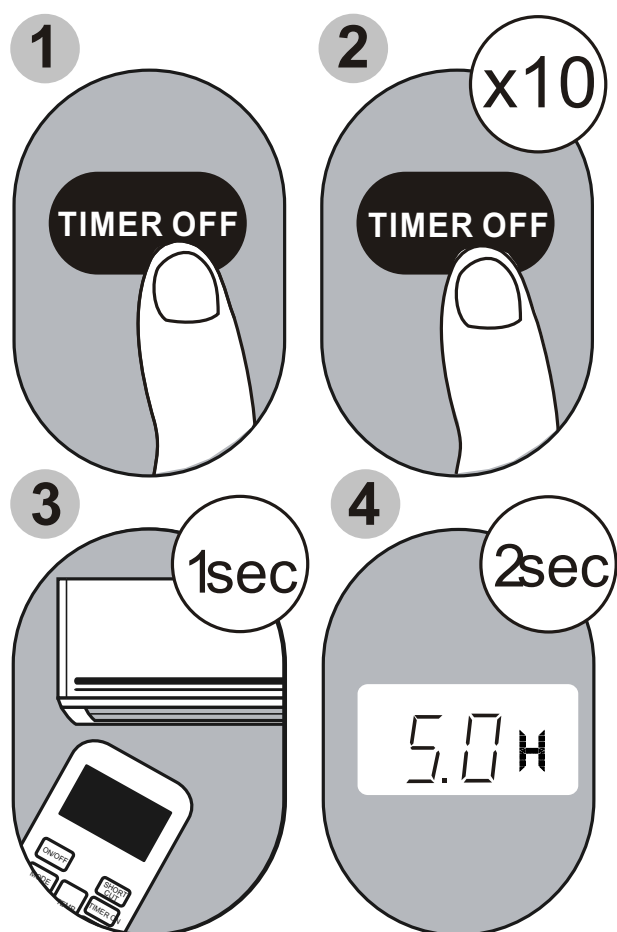

Example: Setting unit to turn off after 5 hours.

NOTE: When setting the **TIMER ON** or **TIMER OFF** functions, up to 10 hours, the time will increase in 30 minute increments with each press. After 10 hours and up to 24, it will increase in 1 hour increments. The timer will revert to zero after 24 hours. You can turn off either function by setting its timer to " 0.0h " .

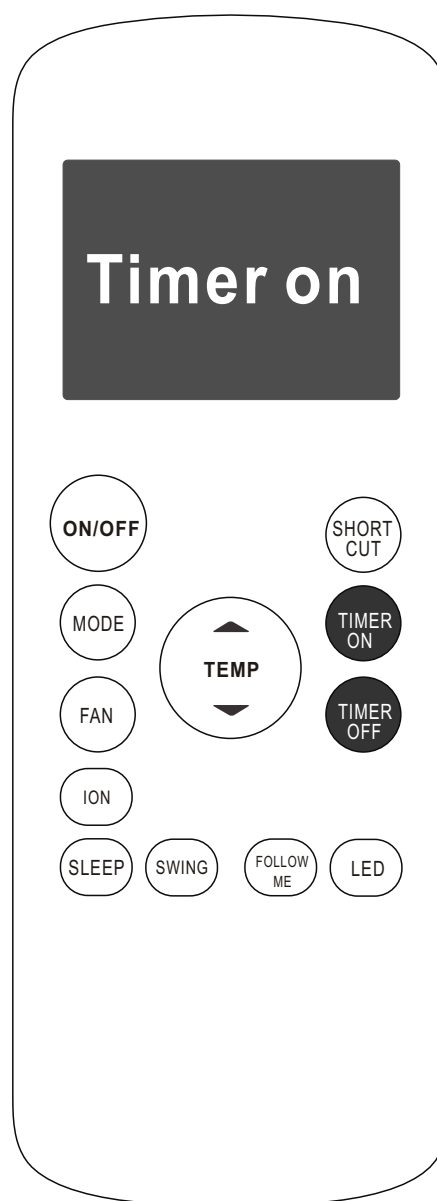

Continue to press **TIMER ON** or **TIMER OFF** until desired time is reached.

Setting both TIMER ON and TIMER OFF at the same time

Keep in mind that the time periods you set for both functions refer to hours after the current time. For example, say that the current time is 1:00 PM, and you want the unit to turn on automatically at 7:00 PM. You want it to operate for 2 hours, then automatically turn off at 9:00 PM.

Do the following:

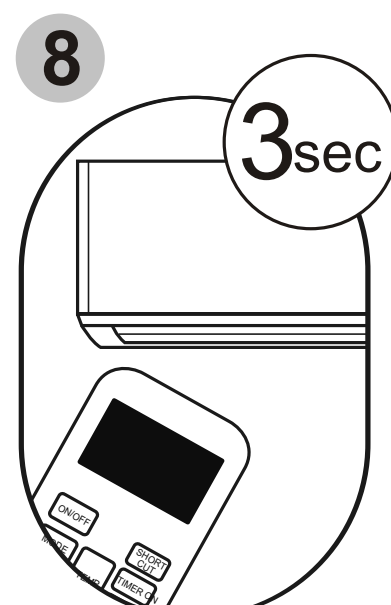
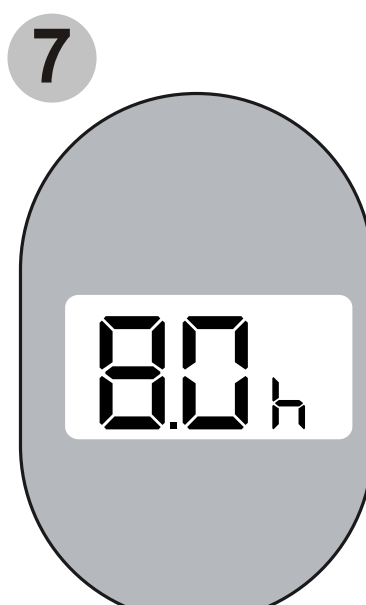
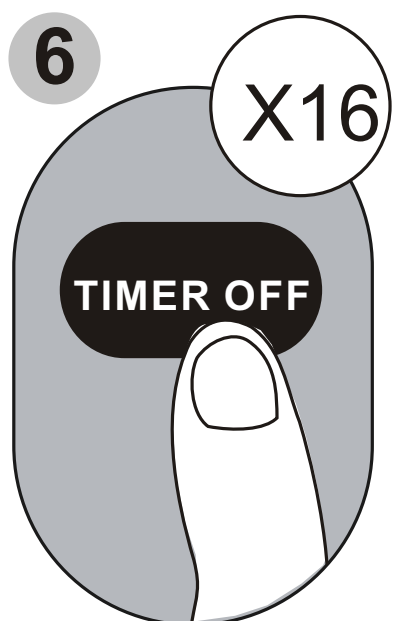
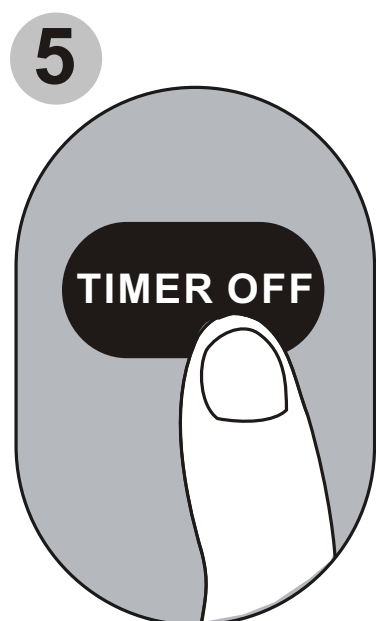
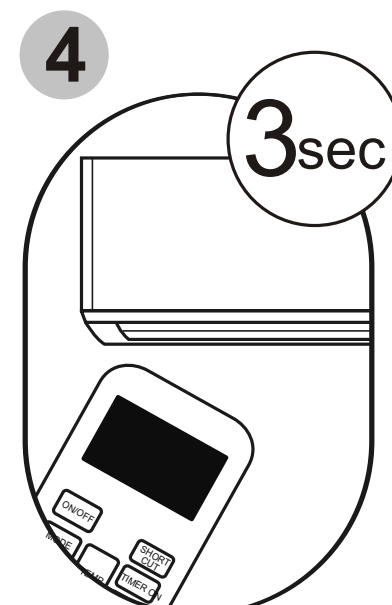
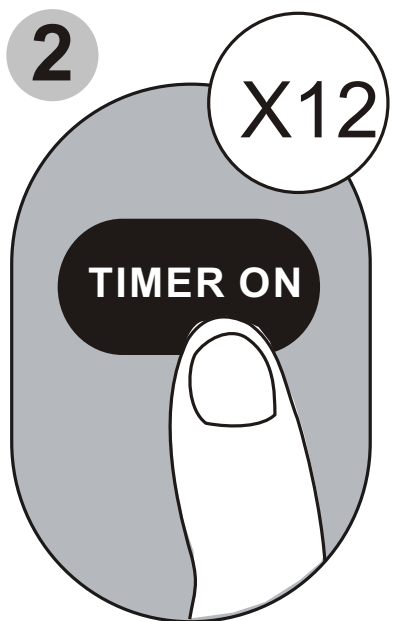

Example: Setting the unit to turn on after 6 hours, operate for 2 hours, then turn off (see the figure below)

Your remote display

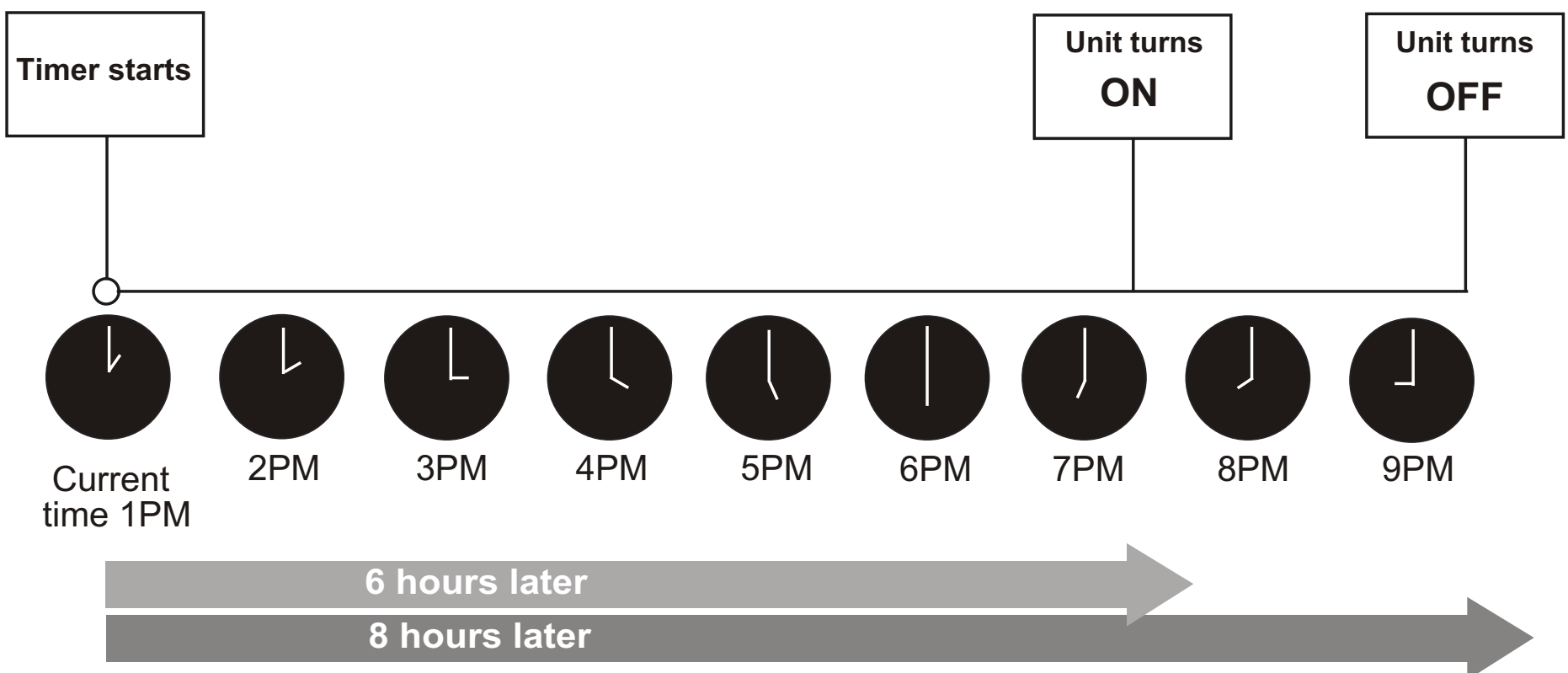
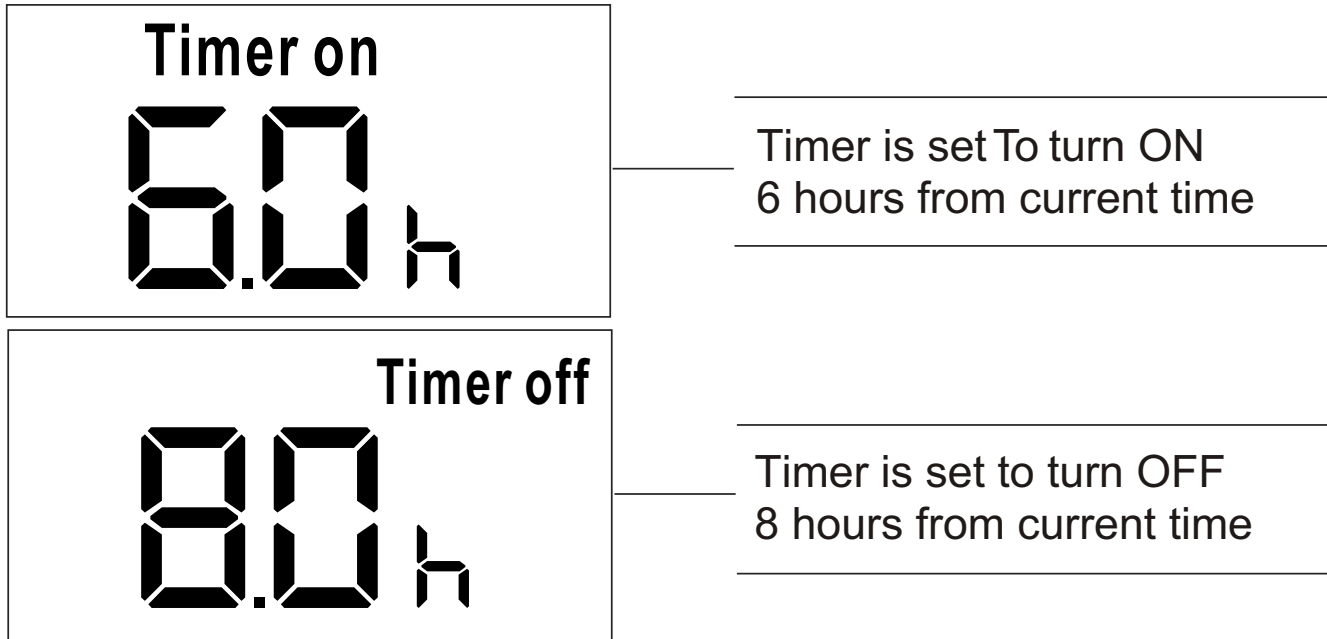

How To Use The Advanced Functions

SLEEP Function

The SLEEP function is used to decrease energy use while you sleep (and don't need the same temperature settings to stay comfortable).

Note: The SLEEP function is not available in FAN or DRY mode.

SWING Function

Used to stop or start louver movement and set the desired up/down air flow direction. The louver changes 6 degrees in angle for each press (some models without). If keep pushing more than 2 seconds, the louver auto swing feature is activated.

FOLLOW ME function

The FOLLOW ME function enables the remote control to measure the temperature at its current location. When using AUTO, COOL, or HEAT functions, measuring ambient temperature from the remote control (instead of from the indoor unit itself) will enable the air conditioner to optimize the temperature around you and ensure maximum comfort.

1. Press **FOLLOW ME** button to activate function. The remote control will send temperature signal to the unit every three minutes.
2. Press **FOLLOW ME** button again to turn off this function.

SHORTCUT function

- Used to restore the current settings or resume previous settings.
- Push this button when remote controller is on, the system will automatically revert back to the previous settings including operating mode, setting temperature, fan speed level and sleep feature (if activated).
- If pushing more than 2 seconds, the system will automatically restore the current operation settings including operating mode, setting temperature, fan speed level and sleep feature (if activated).

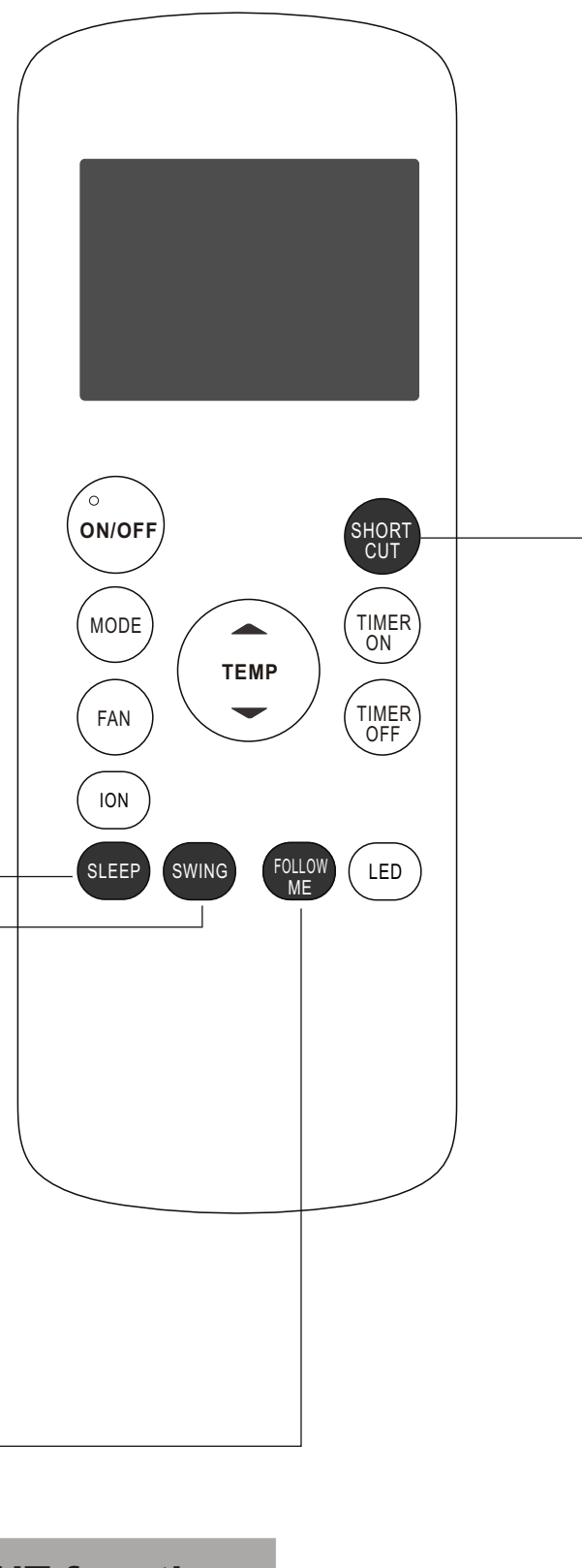

NOTE:

- Buttons design is based on typical model and might be slightly different from the actual one you purchased, the actual shape shall prevail.
- All the functions described are accomplished by the unit, if the unit has no this feature, there is no corresponding operation happened when press the relative button on the remote controller.
- When there are wide differences between“Remote controller Illustration” and“USER’S MANUAL” on function description, the description on“USER’S MANUAL” shall prevail.

The design and specifications are subject to change without prior notice for product improvement. Consult with the sales agency or manufacturer for details.

CR190-RG57H(C)CDT